

Lee's Summit High School
400 SE Blue Parkway
Lee's Summit, MO

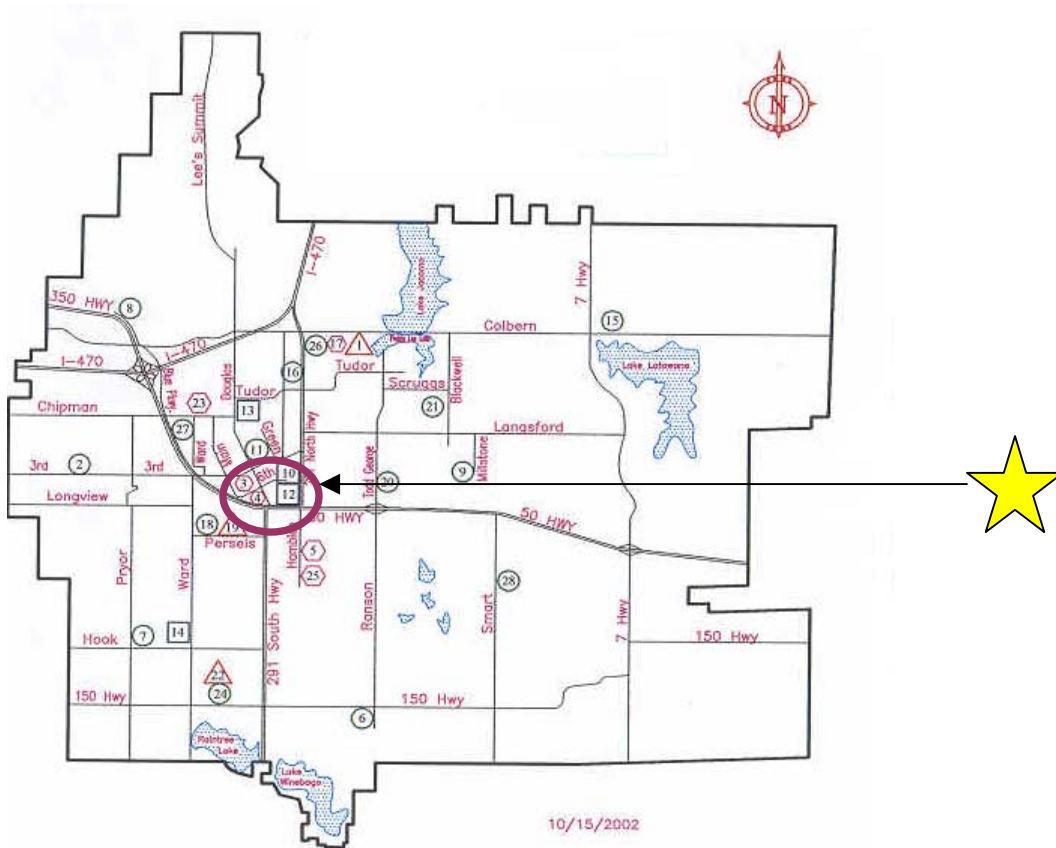

DIRECTIONS TO LEE'S SUMMIT HIGH SCHOOL:

LSHS is located at 400 SE Blue Pkwy. at the northwest corner of SE Blue Pkwy. and MO-291 S. SE Blue Pkwy. is an outer road of 50 Hwy. (on the north side of 50 Hwy.).

From I-70 E Merge onto I-470 S/ MO-291 S via exit number 15A toward LEE'S SUMMIT. (6.51 miles)

Merge onto MO-291 S via exit number 10B- on the left- toward LEE'S SUMMIT/ HARRISONVILLE (3.33 miles)

Turn RIGHT onto SE BLUE PKWY. (0.20 miles)